

FOR CONTINUATION REFER RIGHT

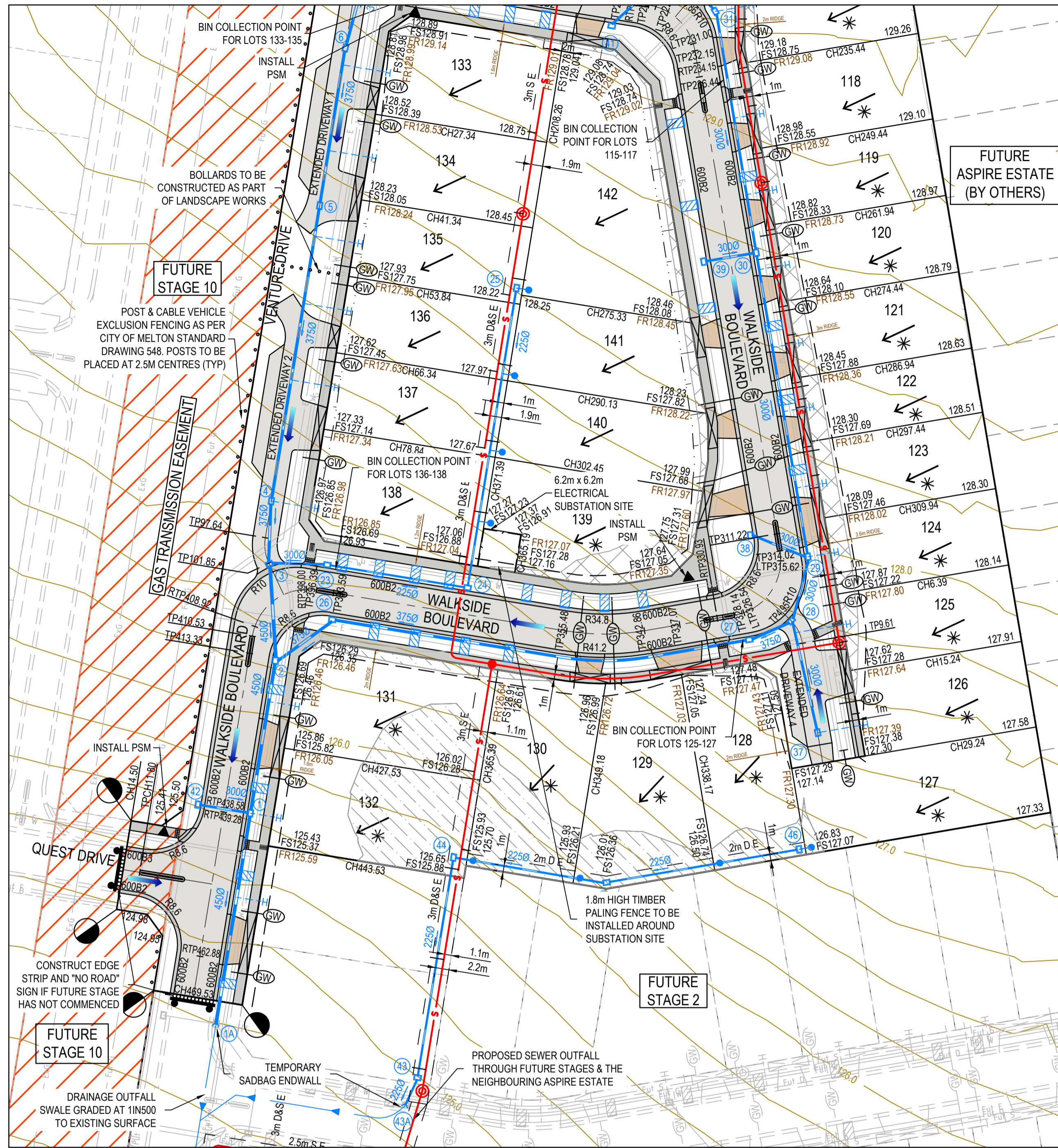

FOR CONTINUATION REFER 2152E-01-04

ROAD LAYOUT TABLE									
ROAD NAME	ROAD CLASSIFICATION	ROAD RESERVE WIDTH (m)	ROAD WIDTH (m)			KERB TYPE		VERGE WIDTH (m)	
			LIP TO LIP	INV TO INV	BACK TO BACK	NTH/WEST	STH/EAST	NTH/WEST	STH/EAST
BEATTYS ROAD	AS1	60.00	8.40	9.30	9.60	600B2	600B2	4.4.55	5.85
WALKSIDE BLVD	AS1	14.50	6.40	7.30	7.60	600B2	600B2	2.70	4.20
WALKSIDE BLVD	AS1	16.00	6.40	7.30	7.60	600B2	600B2	4.20	4.20
MARCH ROAD	AS1	16.00	6.40	7.30	7.60	600B2	600B2	4.20	4.20
QUEST DRIVE	AS1	14.50	6.40	7.30	7.60	600B3	600B2	4.20	2.70
VENTURE DRIVE (EXTENDED DRIVEWAYS)	AP	12.50	4.00	-	-	-	-	4.00	4.50
WALKSIDE BLVD (EXTENDED DRIVEWAYS)	AP	12.00	4.00	-	-	-	-	3.10	4.90

SERVICES OFFSET TABLE				
ROAD NAME	GAS	WATER	ELECTRICITY	OPTIC FIBRE
BEATTYS ROAD	2.60 S	3.20 S	1.65 N*	2.40 N*
WALKSIDE BLVD (LOT102 TO LOT113)	2.10 E	2.60 E	1.10 W	0.40 W
WALKSIDE BLVD (LOT131 TO STG BDY)	2.10 E	2.60 E	1.05 W	0.30 W
VENTURE DRIVE (LOT133 TO LOT138)	2.10 E	2.60 E	3.60 E	1.00 E
MARCH ROAD	2.10 N	2.60 N	2.50 S	1.80 S
WALKSIDE BLVD (LOT113 TO LOT130)	2.10 N/E	2.60 N/E	2.45 S/W	1.80 S/W
WALKSIDE BLVD (SIDE LOT131)	2.10 N	2.60 N	2.70 S	1.00 S #

FOR CONTINUATION REFER 2152E-01-03

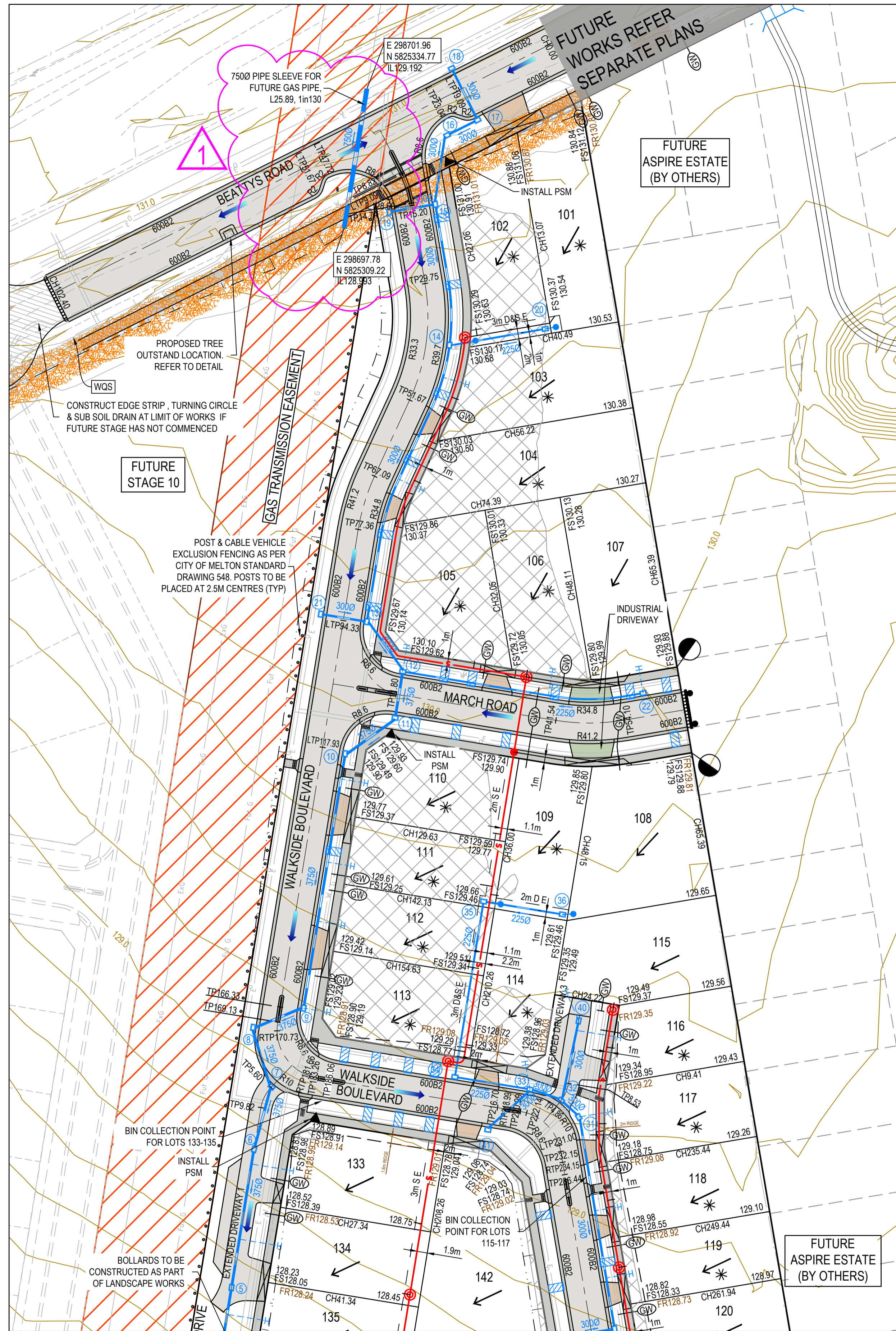

FOR CONTINUATION REFER LEFT

LEGEND - LAYOUT PLAN	
	STORMWATER DRAIN, PIT & PROPERTY INLET
	MAIN DRAIN
	SWALE DRAIN
	SEWER & MAINTENANCE STRUCTURES
	HOUSE DRAIN
	ELECTRICITY (U.GROUND)
	ELECTRICITY (O.HEAD)
	GAS
	TELSTRA
	OPTIC FIBRE
	WATER
	RECYCLE WATER
	AG DRAIN
	SERVICE CONDUITS
	TACTILE PAVERS
	EXISTING STORMWATER DRAIN
	EXISTING MAIN DRAIN
	EXISTING SWALE DRAIN
	EXISTING SEWER & MAINTENANCE STRUCTURES
	EXISTING HOUSE DRAIN
	EXISTING ELECTRICITY (UNDER GROUND)
	EXISTING ELECTRICITY OVERHEAD
	EXISTING GAS
	EXISTING TELSTRA
	EXISTING OPTIC FIBRE
	EXISTING WATER
	EXISTING RECYCLED WATER
	EXISTING AG DRAIN
	EXISTING SERVICE CONDUITS
	EXISTING TACTILE PAVERS
	FUTURE STORMWATER DRAIN
	FUTURE MAIN DRAIN
	FUTURE SWALE DRAIN
	FUTURE SEWER & MAINTENANCE STRUCTURES
	FUTURE HOUSE DRAIN
	FUTURE ELECTRICITY (UNDER GROUND)
	FUTURE ELECTRICITY OVERHEAD
	FUTURE GAS
	FUTURE TELSTRA
	FUTURE OPTIC FIBRE
	FUTURE WATER
	FUTURE RECYCLED WATER
	FUTURE AG DRAIN
	FUTURE SERVICE CONDUITS
	FUTURE TACTILE PAVERS
	ZERO LOT LINES
	EXISTING SURFACE LEVEL
	EXISTING BUILDING LINE LEVEL
	EXISTING RIDGE LINE LEVEL
	CHAINAGE
	TOP OF RETAINING WALL LEVEL
	BOTTOM OF RETAINING WALL LEVEL
	EXISTING RETAINING WALL
	RETAINING WALL
	FUTURE RETAINING WALL
	STRUCTURAL FILL > 200mm DEEP
	EXISTING STRUCTURAL FILL > 200mm DEEP
	CUT > 200mm DEEP
	DIRECTION OF FALL
	OVERLAND FLOW
	GRADED IN DIRECTION OF FALL TO LEVEL INDICATED
	EDGE STRIP, SUBSOIL DRAIN, 'NO ROAD' SIGN & BARRIER
	EXISTING TREE TO BE RETAINED
	EXISTING TREE TO BE REMOVED
	PERMANENT SURVEY MARK
	TEMPORARY BENCH MARK
	PROPOSED DRIVEWAY & FOOTPATH
	PROPOSED INDUSTRIAL DRIVEWAY
	PROPOSED SHARED FOOTPATH
	PROPOSED ROAD PAVING
	EXISTING ROAD PAVING
	IWMS KERB INLET FOR PASSIVE IRRIGATION OF VERGE

WARNING
BEWARE OF UNDERGROUND SERVICES
 The locations of underground services are approximate only and their exact position should be proven on site.
 No guarantee is given that all existing services are shown.
 Locate all underground services before commencement of works.
DIAL 1100 BEFORE YOU DIG
 www.1100.com.au

ISSUED FOR CONSTRUCTION

Global-Mark.com.au

REV	DATE	AMENDMENT / REVISION DESCRIPTION	DESIGNER	APPROVAL
0	17.10.18	ISSUED FOR CONSTRUCTION	NBLIC	SP
1	05.12.18	RE-ISSUED FOR CONSTRUCTION	NBLIC	SP

All setting out should be carried out in accordance with MPA/Council's standard drawings or as nominated on hard copy plans provided by SMEC. Any digital information supplied by this office is for information only. Any discrepancies should be discussed with the superintendent.

TITLE	NAME
DRAFTER	L.Chapple
DESIGNER	D.Severino
CHECKED	S.Pellew
AUTHORISED	S.Crane
REFERENCE No. 1	
REFERENCE No. 2	

Scale 1:500

SCALE AS SHOWN AT 1

SMEC

Member of the Surbana Jurong Group

ABN 47 065 475 149

Level 10, 71 Queens Road
 Melbourne, VIC 3004
 Ph 03 9514 1500

WESTWOOD

Westwood - Stage 1
 Melton City Council
 Road and Drainage
 Layout Plan - 1

MELWAYS REF: 356 B1
 PROJECT / DRAWING No: 2152E-01-02
 SHEET No: 02 of 31
 REVISION: 1