



WESTWOOD

STAGE 1A



STAGE 1A



Directly adjacent to the community's 1.2km green central spine 'The Walk', Westwood's first land release offers a limited selection of 22 lots ranging from 350m² to 837m². This diverse range of homesites ensures a variety of choice, catering for all home requirements, budgets and lifestyles.

Be the first to put down roots in this exciting new community in Melbourne's North West.

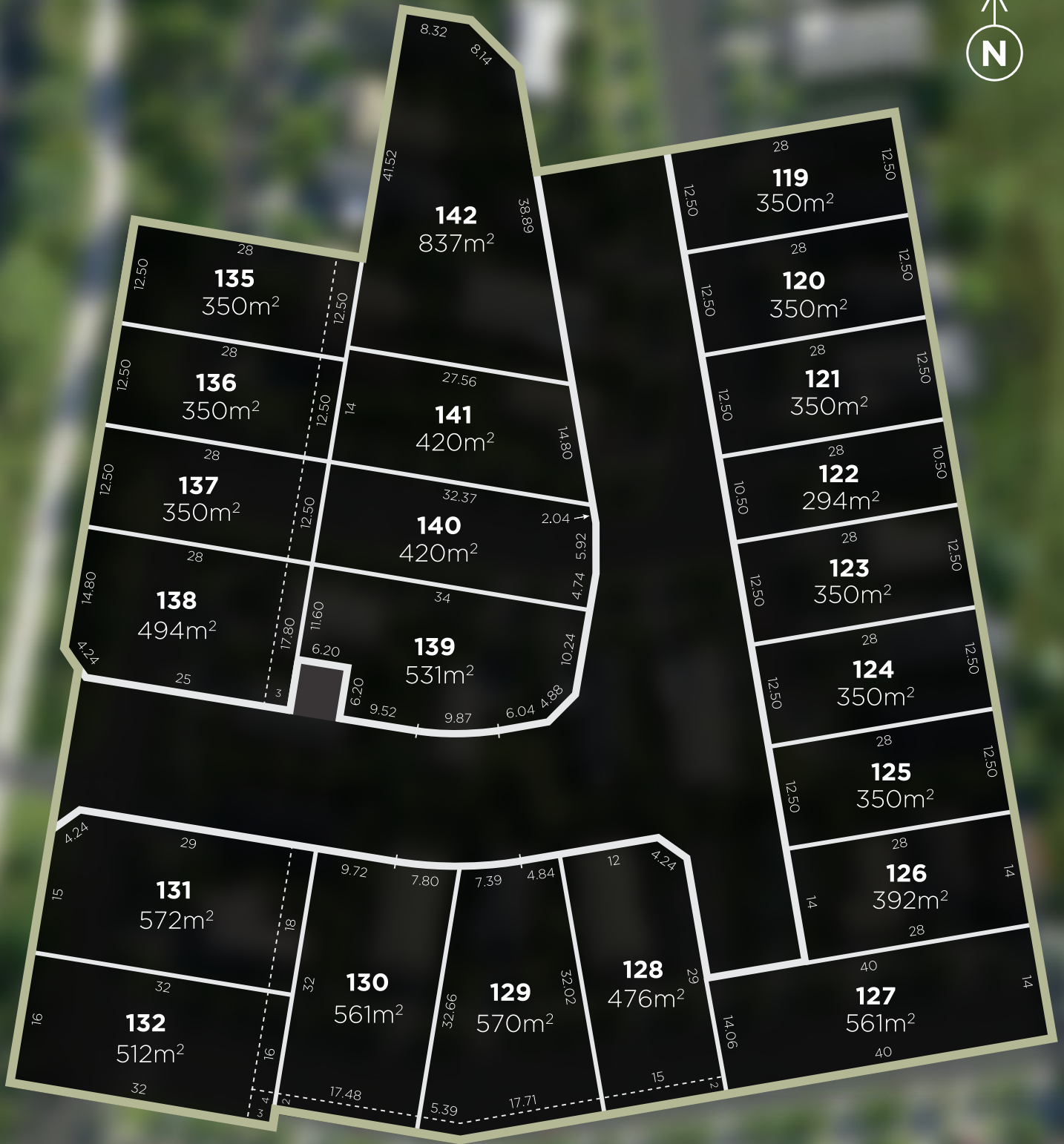

While best efforts have been made to ensure the accuracy of information within this publication, Westwood, its consultants, agents and related entities accept no responsibility for any errors or inaccuracies. Prospective purchasers should make their own enquiries to verify the information herein. Images are artist impressions only.



*Artist's Impression

westwood@rpmrealestate.com.au | 0437 699 633

Land Sales Office open 7 days. 11am - 5pm. 235 Beattys Rd, Plumpton
westwoodland.com.au